

THOMAS POINTER (OSAGE/GASCONADE/WRIGHT CO MO) – by Thomas Stephen Neel, New London OH

Thomas Pointer, son of George and Joannah (Tackett) Pointer, was born 11 Oct 1817 in St. Louis Co MO and died in 1880 in Wood Twp., Wright Co MO. He was buried in Burras-Pointer Cemetery, Dawson MO. The tombstone says “Thomas Pointer 1817-1880 Gone but not forgotten”. He was married first about 1836 to Nancy Gilmore, daughter of Samuel and Amy (Housley) Gilmore, who was born 27 Dec 1819 in Grainger Co TN and died in 1861 in Jefferson Twp., Greene Co MO. Thomas Pointer was married second 16 Jul 1863 Osage Co MO (v. B, p. 32) by Reubin Cox, Justice, to Nancy “Milly” McCarty.

As to early life, Thomas Pointer’s parents were George Pointer and Joannah Tackett who were married 1 Sep 1801 in Wayne Co KY. An extensive group of Pointers were in Gasconade Co MO by 1810 when they signed a petition in the then Louisiana Territory – William Pointer, George Pointer, Joseph Pointer, Cornelius Pointer, John Pointer, George Pointer Sr., and a second Joseph Pointer [Territorial Papers of the United States, by George Edwin Carter, 1949, v. 14, pp. 382-384, 397]. George Pointer died in 1823. His will, made 3 Oct 1823 and filed for probate on 28 Oct 1823 in Gasconade Co MO lists his widow Joanna, with the estate to be divided amongst the children, not named. This case was settled 26 Apr 1830 (Gasconade Co MO Probate Minutes, Vol. C, p. 43). There is a filing in Gasconade Co MO on 10 Nov 1845 for a George Poynter, who “died intestate” (means without a will). I do find where Joannah’s administration of this estate was revoked 6 Nov 1845 (Gasconade Co MO Probate Minutes, Vol. D, p. 45). Then the court appoints John Phillips as Administrator on 10 Nov 1845 (Gasconade Co MO Letters of Administration, Vol. A, p. 155; and Bond, Vol. A, p. 139). The same Phillips had sued Joannah Poynter 6 Aug 1827 as to the delay in settling George Pointer Sr.’s estate (Gasconade Co MO Probate Minutes, Vol. C, p. 2). One would guess that this second George left no wife or children and the heirs are the mother and siblings, but I would like to see that record for myself (source is genealogical correspondence). The court packets do survive and I plan to order them. Joannah Pointer was living adjacent to our Thomas Pointer in 1850. St. Louis Co MO was formed in 1812 and was an original county. Franklin County was created in 1818 from St. Louis. Gasconade County was created in 1820 from Franklin. Osage County was created in 1841 from Gasconade. We have to follow that route even though the family moved little geographically from their first settlement just prior to 1810.

The first mention of our ancestor isn’t the best! The circuit court minutes for Gasconade Co MO (Vol. A, p. 163-164) mention State vs. Thomas Poynter, Indictment for felonious assault with intent to kill, term of 12 Dec 1836. The case is mentioned again 17 Apr 1837 (Vol. A, p. 164) with the note “alias capias to Pulaski County”. The cause is finally heard on 21 Aug 1837 (Vol. A, p. 171-172), where Thomas Poynter pleads “not guilty”. A jury is called. They find him “guilty” on the first count, fined \$15, and “guilty” on the second count, fined \$15. He also had to pay the costs of the prosecution. He must have been in a serious fight.

The heirs of George Pointer are actually implied in an 1839 deed concerning slaves owned by the family. James Poynter, Thomas Poynter, William Poynter, Sally and Thomas Owens, Elizabeth Poynter, and Jonah [sic] Poynter, and Amy and James Jett, “heirs of Jonah Poynter,” all of Gasconade Co MO, for consideration of \$1100, sell to William Kerley of Gasconade County, “all our rights all interest and claims in and to the following property to wit, one negro woman named Doll aged about 23 years, also her children, one named Phebe aged about seven years, also Bell aged about 4 years old, said slaves are now in the possession of the said William Kerley.” This document is dated 1 Feb 1839. It is signed only by James Poynter, William Poynter, John Phillips and Joanna Phillips [Gasconade Co MO Deeds, Vol. E, p. 327]. The deed was not recorded until 3 May 1845 by J. B. Harrison, Recorder. The child, Joanna Pointer, must have gotten married to John Phillips between 1839 and 1845, since John was not named

in the deed (indeed in 1843). This document is vital to the study of our family. The slave Doll was given by George Pointer to his wife Joanah in the 1823 will, Joanah sells Doll and her two daughters to William Kerley, and it is felt that George's heirs still need to sign off. The question could be posed, could this group of siblings be "heirs" if the mother Joanah (Jonah in this document) is still living? Let's hope so, or this family structure will get real confusing!

Thomas Pointer is listed in the 1840 census for Gray Twp. (but Bolware Twp. in printed index), Gasconade Co MO, p. 251, age 20-30, wife 20-30, male under 5, and female under 5. Neighbors were: Wm. Miller, James Pointer, and Robert Phelps. Perhaps the female was a child born ca. 1839 that died young but a date is apparently not given in the Pointer Family Bible. We only have a transcription of the Bible prepared by Inez Mitchem of Cabool MO in the 1950s.

Since Osage County was formed in 1841, deeds for the parent county of Gasconade were checked. There are many Pointer deeds but none that mention Thomas. However, there is a US patent filed 1 Oct 1840 at the St. Louis Land Office (v. M670, p. 219, #7442 Missouri), a cash entry, under the Act of 24 Apr 1820, by Thomas Pointer of Gasconade Co MO for 40 acres in Osage Co MO, being the 5th Prime Meridian, Twp. 43 N, Range 8 W, SE ¼ of the NE ¼ of Sect. 36. Neighbors in this section with other original land patents were James Jett, James Pointer, Joannah Pointer, William Pointer, and Gideon West.

Thomas Pointer and his wife Nancy of Osage Co MO sold 40 acres for \$100 to David Branson of Osage Co on 5 Feb 1846. The land is noted as "per duplicate No. 7442" so is the patent land acquired in 1840. The description is the SE ¼ NE ¼ Sect. 36 Twp. 43 Range 8W. Thomas and Nancy Pointer both signed with their X mark rather than a signature. The deed was recorded 5 Feb 1846 by E. McJilton, Clerk [Osage Co MO Deeds, Vol. B, p. 272-274].

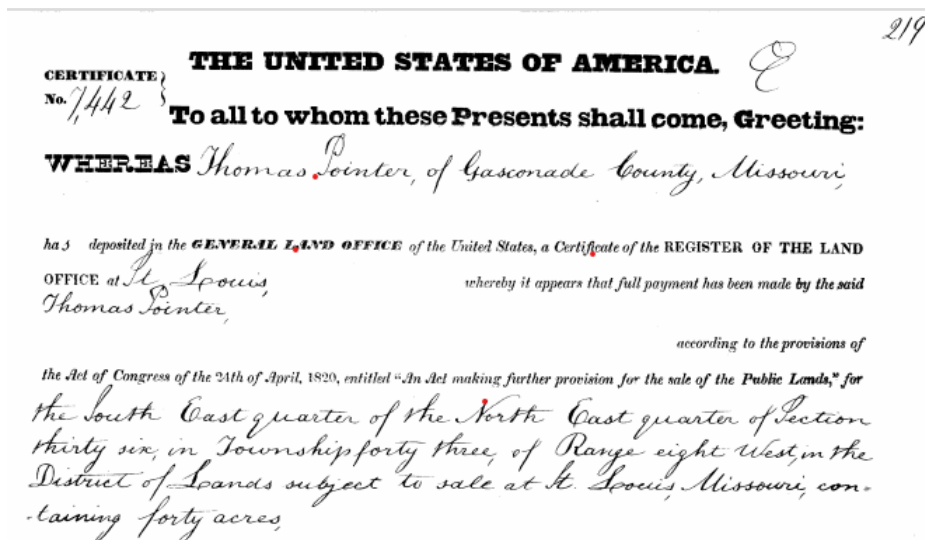

A couple months later, on 17 Aug 1846, John Crouch and his wife Jane, for \$100, sell to Thomas Pointer, land in Osage County, 40 acres in the SW ¼ of Section [blank], Twp. "1-2" [?] of Range 7 W. Reuben Cox was the Justice of the Peace who witnessed the transaction. John Crouch signs the deed and Jane makes her X mark. This was recorded 15 Nov 1846 by E. McJilton, Clerk [Osage Co MO Deeds, Vol. B, p. 455-456]. A review of the land patents suggest that John Crouch only received one tract (1 Oct 1835) in the

SW ¼ of the NE ¼ of Section 1 of Twp. 42 N, Range 7 W, so this fills in the missing information on this deed. However, the later Pointer deeds seem to suggest that this is in Section 10, not Section 1.

In the 1850 census, Thomas Pointer was listed in Crawford Twp., Osage Co MO, p. 442, age 32 MO laborer, with wife Nancy 31 TN, and several presumed children: Martha 12, William 10, Joanna 8, Ora 7, and James 1 month, all born in Missouri. Living with the family were Elizabeth Roach 32 MO and Joanna Pointer 65 NC. Neighbors were: Matilda Dodson and James Pointer. Osage County was formed in 1841 from Gasconade County, so it is likely that the family had not moved between censuses.



On 6 Sep 1853, Thomas Pointer of Osage Co MO for \$25 purchases 82 acres from Reuben Cox and wife Rachel of Osage Co. The land is the W ½ NW ¼ Sect. 22 Twp. 42 N, Range 7 W. Reubin [sic] Cox signs the deed and Rachel makes her mark. It was recorded 23 Sep 1853 by W. M. Lamkin, Clerk [Osage Co MO Deeds, Vol. E, p. 101]. Pointer owns roughly 122 acres at this point in two tracts. There were four land sales and another purchase in 1854-1855 that make it a little more confusing!

Indenture, 7 Jul 1854, Thomas Pointer and wife Nancy of Osage Co MO to William J. Williams of Osage Co., consideration \$25, land in Osage Co., SW ¼ NW ¼ Sect. 22, Twp. 42, Range 7 W, acreage not given [probably 40 acres], signed Thomas Pointer and Nancy her X mark Pointer, witnessed by William Cox JP, recorded 7 Aug 1854 by Wm. M. Lamkin, Clerk [Osage Co MO Deeds, Vol. E, p. 286-287].

Indenture, 25 Jul 1854, Thomas Pointer and wife Nancy to David Gilmore, all of Osage Co., consideration \$25, land in Osage Co., NW ¼ NW ¼ Sect. 22, Twp. 42, Range 7W, acreage not given [probably 40 acres], both signed by mark, witnessed by William Cox JP, recorded 25 Aug 1854 by Wm. M. Lamkin, Clerk [Osage Co MO Deeds, Vol. E, p. 304-305].

Indenture, 19 Feb 1855, Thomas Pointer and wife Nancy of Osage Co MO to James Pointer of Osage Co., consideration \$10, land in Osage Co., W part NE ¼ SW ¼ Sect. 10, Twp. 42, Range 7W, also part of the W part SE ¼ NW ¼ of the same section, the later being 3 acres, with the total of both tracts being 23 acres, both signed by mark, witnessed by William Cox JP, recorded 31 Mar 1855 by Wm. M. Lamkin, Clerk [Osage Co MO Deeds, Vol. E, p. 469-470].

Indenture, 19 Feb 1855, Henry E. Cox and wife Luisey of Osage Co MO to Thomas Pointer of Osage Co., consideration \$10.50, land in Osage Co., being 8 acres in SE corner SE ¼ NW ¼ Sect. 10, Twp. 42, Range 7W, on the southeast side of Mistaken Creek as low down as the mouth of the branch that is known by

the name of the Cal Harris Branch, signed by Henry G. [sic] Cox and Louis [sic] X mark Cox, witnessed by William Cox JP, recorded 2 Apr 1855 by Wm. M. Lamkin, Clerk [Osage Co MO Deeds, Vol. E, p. 471-472].

Indenture, 27 Mar 1855, Thomas Pointer and wife Nancy of Osage Co MO to Elizabeth Roach of Osage Co., consideration \$80, 5 acres of the SE corner of SE ¼ NW ¼ Sect. 10, Twp. 42, Range 7W, also 63 acres of E ½ SW ¼ Sect. 10, Twp. 42, Range 7W, both signed by mark, witnessed by Gideon R. West JP, recorded 2 Apr 1855 by Wm. M. Lamkin, Clerk [Osage Co MO Deeds, Vol. E, p. 470-471].

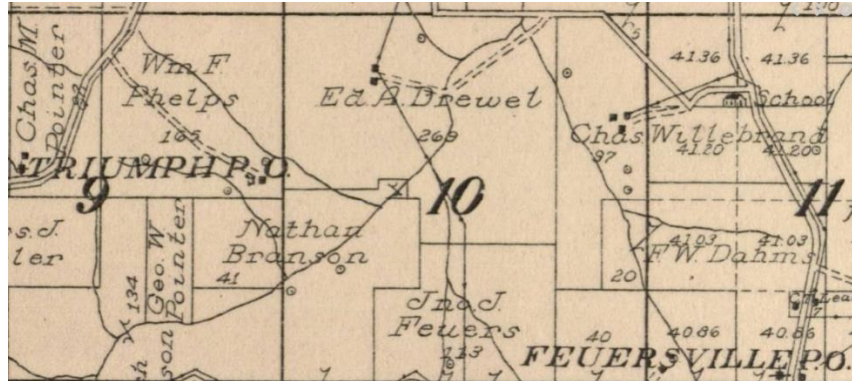

After all these transactions, of the 80 acres in Sect. 22 (surveyed as 82 acres), 40 are sold to Williams and 40 are sold to Gilmore. Of the 40 acres in Sect. 10, 23 are sold to James Pointer and 68 are sold to Roach, Thomas Pointer meanwhile purchasing 8 more acres in Sect. 10 from Cox. The math doesn't quite add up here, so there is something else in play somewhere.

The answer might be with a second US land patent, issued to Thomas Pointer of Osage Co MO on 10 Jun 1857 for 82.76 acres (St. Louis Land Office, cash entry, Act of 24 Apr 1820, #25962 Missouri). The land was in the 5th Prime Meridian, Twp. 42 N, Range 7W, E ½ SW ¼, Section 10. This is that same section in question. Perhaps he started his dealings in advance of the final issue of the document. Neighbors with land entries in the same section were: Carl W. Bender, Thomas C. Branson, Henry I. Cox, Abraham Crider, Bayless West, and Robert Kinear. This should give Pointer a slight surplus of acreage after all the transactions are considered rather than a deficit.

Thomas Pointer is found in the 1860 census in Jefferson Twp., Osage Co MO, p. 298-299. He is age 42 MO farmer \$50/\$150 no read or write, with wife Nancy 40 TN no read or write, and likely children: Martha 21 MO no read or write, Wm. D. 20 MO farmer, Johanna 18 MO, Elizabeth 16 MO, James 10 MO, Edward 8 MO, Mary 6 MO, and Geo. W. 4 MO. Listed next in the household is Wm. L. Butler 1 MO with \$200/\$175. It isn't known why a 1- year (if accurate) would have real and personal estate. Then is J. Pointer 5 months MO "female", but this would almost have to be John Andrew Pointer. Then a farm laborer, John Baker 19 MO, closes out the Thomas Pointer household. Neighbors were: Charles Grunner and Christian Fance. It should be noted that none of the Pointer children were listed as attending school in the census year.

Nancy (Gilmore) Pointer, the first wife of Thomas Pointer and mother of his children, died in 1861 in Jefferson Twp., Osage Co MO. I am not finding my source for that. It may be derived from the transcription of the Pointer Family Bible. It apparently says that Nancy died at age "61" but with no death date. Perhaps it was 1861? She was alive when the 1860 was taken; she was likely deceased by the date of Thomas Pointer's second marriage in 1863. Many relatives (on the Internet) have added "61"

to her 1819 birthdate and have computed an 1880 death date for Nancy Pointer. This is likely incorrect unless she had divorced her husband.

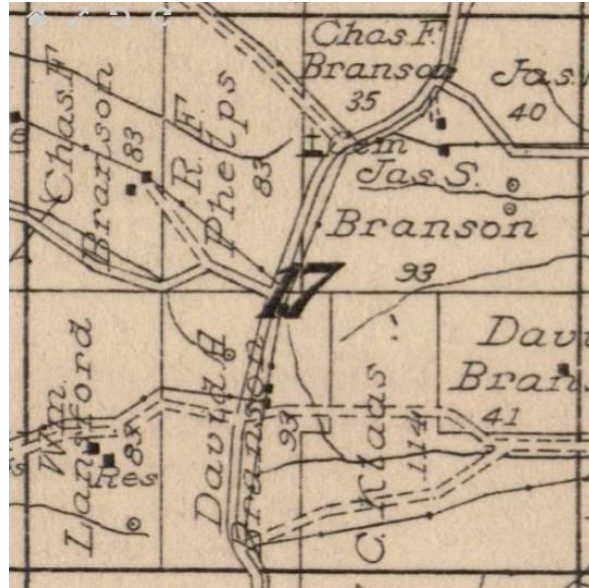

Of interest in furthering the study of the probable death of the first wife, Nancy Gilmore Pointer, is a quit claim deed filed in 1886. Charles Pointer, Elizabeth J. Pointer, Jarvis L. Rollins, Mary J. Rollins, and Jesse K. Spurgin, all of Osage Co. MO, quit claim to the Osage County Court, land in trust to be used as a public burial ground, in Osage Co., a piece of SW corner NW $\frac{1}{4}$ NE $\frac{1}{4}$, a piece of NW corner SW $\frac{1}{4}$ NE $\frac{1}{4}$, a piece of NE corner SE $\frac{1}{4}$ NW $\frac{1}{4}$, and a piece of SE corner NE $\frac{1}{4}$ NW $\frac{1}{4}$, all in Sect. 17, Twp. 42, Range 7W, measuring south 50 yards, west 30 yards, north 60 yards, south 52 yards, and 50 yards to point of beginning along the road. This was signed by Chas. Pointer, Elizabeth J. Pointer, J.L. Rollins, Mary J. her X mark Rollins, and Jesse K. Spurgeon [sic]. It was witnessed by F.A. Hassler JP and recorded on 17 Dec 1866 by E. F. Bantzer, Clerk [Osage Co MO Deeds, Vol. 5, p. 308-309]. One wonders if Nancy Pointer might be buried here as well as other earlier members of the Pointer family who died in Osage County? The cemetery is marked with a cross on the later atlas image pictured here. There are also cemeteries very close to the location of other Thomas Pointer land tracts.

Thomas Pointer was married second on 16 Jul 1863 in Osage Co MO by Reubin Cox JP to Nancy McCarty of Osage County (Vol. B, p. 32).

I do certify that I solemnized a marriage
between Thomas Pointer and Nancy Ma-
carty of Osage County Missouri this the 16th
day of July 1863. Reuben Lott Justice
of the Peace
Filed for record Sept 7th 1863. I duly re-
corded
M. Sankin Clerk
of Office Recorder by J. Evelyn D.

Thomas Pointer's final land dealings were in 1866. An abstract of the sale of school lands whereas Thomas Pointer became the purchaser were deposited with the Register of Lands. This was 41 acres in NE ¼ SW ¼ Sect. 16, Twp. 42, Range 7, which he had bought at \$1.25 per acre from the State of Missouri for the inhabitants of said township for the use of schools, totaling \$51.82. The amount had been submitted by Pointer and patent issued by Thos. C. Fletcher, Governor of Missouri, on 28 Jun 1866. Witnessed by Francis Rodman, Secretary of State. Recorded in Osage County 5 Nov 1866 by C. Glover, Clerk [Osage Co MO Deeds, Vol. L, p. 403-404].

I'm not quite certain when Pointer actually filed for the school lands, but he had already sold it off by the time of the patent date. Thomas Pointer and wife Milia N. of Osage Co MO to Martha Ousley of Osage Co., consideration \$61.50, land in Osage Co., NE ¼ SW ¼ Sect. 16, Twp. 42, Range 7, 41 acres, dated 13 Oct 1866. Both the Pointers sign by their mark instead of a signature. It was witnessed by Lewis Phillips JP and recorded 5 Nov 1866 by C. Glover, Clerk, the same day that the school land patent was recorded [Osage Co MO Deeds, Vol. L, p. 402-403]. There are additional deeds and a lawsuit concerning school land funds filed by some of Thomas Pointer's children in the 1880s (Osage Co MO Deeds – mostly Vol. 5, p. 125, 224, 424), but I don't quite see a relationship to this tract, although I could be mistake. Note that this deed is the only one signed by the second wife. The purchaser is an Ousley; the first wife Nancy Gilmore's mother was an Ousley/Housley.

THE UNITED STATES OF AMERICA,
CERTIFICATE }
No. 25762 }

To all to whom these presents shall come, Greeting:

Whereas Thomas Pointer of Osage County, Missouri,

has deposited in the GENERAL LAND OFFICE of the United States, a Certificate of the REGISTER OF THE LAND OFFICE at St. Louis whereby it appears that full payment has been made by the said

Thomas Pointer according to the provisions of the Act of Congress of the 24th of April, 1820, entitled "An act making further provision for the sale of the Public Lands," for

The East half of the South West quarter of Section Ten in Town Ship forty-two North of Range Seven West, in the District of lands Subject to sale at St. Louis, Missouri containing eighty-two acres and seventy-six hundredths of an acre

In the 1870 census, Thomas Painter [sic] 53 TN farmer with \$150/\$100 is noted in Hartville Post Office, Wright Co MO, p. 490b. Milly 29 MO keeping house, is listed next, presumably a second wife. Then come the likely children: Martha J. 35 MO, E.C. 18 (male) MO farmer, Mary A. 16 MO keeping house, George W. 14 MO school, J.A. 11 (male) MO school, and Margaret 10 MO school. Milly and the five young ones cannot read or write. Martha is listed as an "idiot". Neighbors were: J.K.P. Phillips and Robert Thomhill. Census records 1870 and earlier do not state relationships, so familial ties are merely presumed. The youngest, Margaret, is not listed in the Bible record and, looking at the 1880 census, was likely a child brought into the marriage by the second wife.

In the 1880 census for Wood Twp., Wright Co MO, Miley Pointer 33 MO UK UK is listed as a widow and living with a daughter, Margaret McCarthy 18 MO IR MO, who had epilepsy. Thomas Pointer must have died prior to the census date in 1880. The 1880 Missouri mortality schedule which would given an exact date appears to have not survived – at least, it is not on Ancestry. Civil deaths begin in 1910 in Missouri. So, we do not yet have an exact date of death for Thomas Pointer.

The tombstone (courtesy of "Bill" on FindaGrave, is from Pointer-Burriss Cemetery near Dawson in Wood Twp., Wright Co MO. Only three graves are standing here. It says: Thomas Pointer, 1817-1880, Gone but not Forgotten. It is unfortunate that so many court records have been lost in Wright County.



Note that these Missouri counties have had courthouse fires and loss of records. In addition, my visits to Missouri for research have been fleeting. There is perhaps much more available locally. Things we need might include any probate record for Thomas Pointer, a marriage to first wife Nancy Gilmore, a death record or possible further marriage for his second wife, Miley, information on the mother Joannah (Tackett) Pointer – all lacking in what has been found so far. See my story on George and Joannah (Tackett) Pointer. I have addressed the George Pointer heirs more fully. Photographs exist of several of these children of Thomas Pointer and I hope to secure copies of those images and eventually include them here with a little more story on them.

Credit: Correspondents Linda J. Pointer of Columbus OH, Mary Moran of Jackson MI, Julia Rice of Albion IL, and Kelley Bianchi of Coeur d'Alene ID.

Children of Thomas Pointer and first wife Nancy Gilmore:

1. Martha Jane Pointer, b. 5 Nov 1837
2. William David Pointer, b. 8 Mar 1841; m. 11 Nov 1860 Osage Co MO to Winnie F. West
3. Joanna Pointer, b. 18 Jun 1842; d. 2 Apr 1883 Wood Twp., Wright Co MO; bur. Pointer/Burriss Cem., Wright Co MO; m. 8 May 1864 Osage Co MO (v. B, p. 47) to Elias Tilford Spurgeon.
4. Ora Elizabeth Pointer, b. 25 Sep 1844; d. ? Marion Co AR; m. Ananias Poplin.
5. James Calvin Pointer, b. 14 May 1850; m. Mary Catherine Crider.
6. Edwin Smith "Ned" Pointer, b. 7 Mar 1852; d. 18 Jan 1926; bur. Cotter Cem., Baxter Co AR; m. Lurina/Urany Latham/Lathrom.
7. Mary Anna Pointer, b. 28 May 1854; d. 18 Jan 1941 Cabool, Texas Co MO; bur. Stubbs Cem., Clinton Twp., Texas Co MO; m(1) ca. 1874 Wright Co MO to John S. Mitchem; m(2) 14 Nov 1901 Texas Co MO to George Preston Sharp
8. George W. Pointer, b. 6 Aug 1856; d. 5 Apr 1937 Mountain Grove, Wright Co MO; bur. Lone Star Cem., Mountain Grove, Wright Co MO; m(1) 15 Sep 1878 Texas Co MO to Nancy J. Greenlee (Vol. 1, p. 364); m(2) 8 Jan 1885 Texas Co MO to Eliza J. (Pollett) Hodges; m(3) Lilly May --- (name of wife on death certificate).
9. John Andrew Pointer, b. 17 Nov 1858; d. 14 Apr 1934 Cotter, Baxter Co AR; m. 7 Feb 1887 Marion Co AR to Mary Louisa Due

Prepared by Thomas Stephen Neel, 169 East Main Street, New London OH 44851; email address is currently thomasneel1@twc.com but it has changed many times through the years; this version is dated 29 July 2021; updated 4 Aug 2021.